

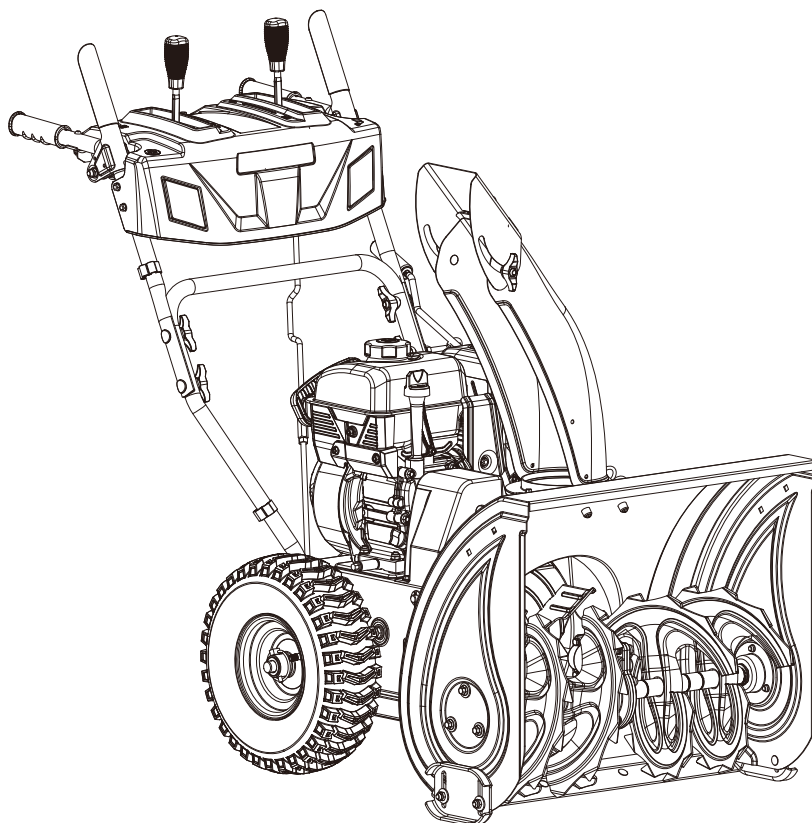

YF24-DS21-GSB3

SNOW BLOWER OWNER'S MANUAL



Our Customer Service staff is ready to provide assistance.

In the case of a damaged or missing part, most replacement parts ship directly from Merotec USA in Atlanta or from one of our service partners in the US.

For immediate help with assembly, or for additional product information, email support@MerotecUSA.com or call 866-902-9690 M-F 8:30am – 5:00pm ET. More information can be found on www.YardForceUSA.com.



SAVE THIS MANUAL FOR REFERENCE

You will need this manual for safety instructions, operating procedures, and Warranty. The original sales receipt is required for warranty service.

TABLE OF CONTENTS

Safety Instructions.....3

Description of Symbols.....8

Parts List.....10

Technical Specifications.....12

Assembly.....13

Operation.....17

Maintenance and Storage.....23

Troubleshooting.....26

Transportation,storage and disposal.....29

Warranty.....30

SAFETY INSTRUCTIONS

GENERAL SAFETY INSTRUCTIONS

1. Use the product correctly. Injury or death is a possible result of incorrect use. Only use the product for the tasks found in this manual. Do not use the product for other tasks.
2. Obey the instructions in this manual. Obey the safety symbols and the safety instructions. If the operator does not obey the instructions and the symbols, injury, damage or death is possible result.
3. Do not discard this manual. Use the instructions to assemble, to operate and to keep your product in good condition. Use the instructions for correct installation of attachments and accessories. Only use approved attachments and accessories.
4. Do not use a damaged product. Obey the maintenance schedule. Only do the maintenance work that you find an instruction about in this manual.
An approved service center must do all other maintenance work.
5. This manual cannot include all situations that can occur when you use the product. Be careful and use your common sense. Do not operate the product or do maintenance to the product if you are not sure about of the situation. Speak to a product expert, your dealer, service agent or approved service center for information.
6. Disconnect the spark plug cable before you assemble the product, put the product into storage or do maintenance.
7. Do not use the product if it is changed from its initial specification. Do not change a part of the product without approval from the manufacturer. Only use parts that are approved by the manufacturer. Injury or death is a possible result of incorrect maintenance.
8. Do not breathe in the fumes from the engine. Long term inhalation of the engine's exhaust fumes is a health risk.
9. Do not start the product indoors or near flammable material. The exhaust fumes are hot and can contain a spark which can start a fire. Not sufficient airflow can cause injury or death because of asphyxiation or carbon monoxide.
10. When you use this product the engine makes an electromagnetic field.
The electromagnetic field can cause damage to medical implants. Speak to your physician and medical implant manufacturer before you operate the product.
11. Do not let a child operate the product. Do not let a person, without knowledge of the instructions operate the product.
12. Make sure that you always monitor a person, with decreased physical capacity or mental capacity, that uses the product. A responsible adult must be there at all times.
13. Lock the product in an area that children and unapproved persons cannot access.
14. The product can eject objects and cause injuries. Obey the safety instructions to decrease the risk of injury or death.
15. Do not go away from the product when the engine is on.
16. The operator of the product is responsible if an accident occurs.
17. Before and while you walk rearward, look behind and down for small children, animals or other risks that can cause you to fall.
18. Make sure that parts are not damaged before you use the product.
19. Make sure that you are at a minimum 15 m (50 ft) away from other persons or animals before you use the product. Make sure that a person in adjacent area knows that you will use the product.
20. Refer to national or local laws. They can prevent or decrease the operation of the product in some conditions.

SAFETY INSTRUCTIONS

TRAINING

1. Read understand and follow all instructions on the machine and in the manual(s) before operating this unit. Be thoroughly familiar with the controls and the proper use of the equipment. Know how to stop the unit and disengage the controls quickly.
2. Never allow children to operate the equipment.
3. Never allow adults to operate the equipment without proper instruction.
4. Keep the area of operation clear of all persons particularly small children.
5. Exercise caution to avoid slipping or falling, especially when operating the snow thrower in reverse.

SAFETY INSTRUCTIONS FOR OPERATION

1. Do not put hands or feet near or under rotating parts. Keep clear of the discharge opening at all times.
2. Exercise extreme caution when operating on or crossing gravel drives, walks, or roads. Stay alert for hidden hazards traffic.
3. After striking a foreign object, stop the engine (motor), remove the wire from the spark plug, disconnect the cord on electric motors, thoroughly inspect the product for any damage, and repair the damage before restarting and operating the product.
4. If the product starts to vibrate abnormally, stop the engine (motor) and check immediately for the cause. Vibration is generally a warning of trouble.
5. Stop the engine (motor) whenever you leave the operating position, before unclogging the auger housing or chute deflector, and when making any repairs, adjustments or inspections.
6. When cleaning, repairing or inspecting the product, stop the engine and make certain the augers and all moving parts have stopped. Disconnect the spark plug wire and keep the wire away from the plug to prevent someone from accidentally starting the engine.
7. Do not run the engine indoors, except when starting the engine and for transporting the product in or out of the building. Open the outside doors; exhaust fumes are dangerous.
8. Exercise extreme caution when operating on slopes.
9. Never operate the product without proper guards, and other safety protective devices in place and working.
10. Never direct the chute deflector toward people or areas where property damage can occur. Keep children and others away.
11. Do not overload the product capacity by attempting to clear snow at too fast a rate.
12. Never operate the product at high transport speeds on slippery surfaces. Look behind and use care when operating in reverse.
13. Disengage power to the augers when the product is transported or not in use.
14. Use only attachments and accessories approved by the manufacturer of the product (such as wheel weights, counterweights, or cabs).
15. Never operate the product without good visibility or light. Always be sure of your footing, and keep a firm hold on the handles. Walk; never run.
16. Never touch a hot engine or muffler.

WORK AREA SAFETY

1. Thoroughly inspect the area where the equipment is to be used and remove all doormats, sleds, boards, wires, and other foreign objects.

SAFETY INSTRUCTIONS

2. Disengage all clutches and shift into neutral before starting the engine (motor).
3. Do not operate the product without wearing adequate winter garments.
Avoid loose fitting clothing that can get caught in moving parts. Wear footwear that will improve footing on slippery surfaces.
4. Handle fuel with care; it is highly flammable.
 - a. Use an approved fuel container.
 - b. Never add fuel to a running engine or hot engine.
 - c. Fill fuel tank outdoors with extreme care. Never fill fuel tank indoors.
 - d. Never fill containers inside a vehicle or on a truck or trailer bed with a plastic liner. Always place containers on the ground, away from your vehicle, before filling.
 - e. When practical, remove gas-powered equipment from the truck or trailer and refuel it on the ground. If this is not possible, then refuel such equipment on a trailer with a portable container, rather than from a gasoline dispenser nozzle.
 - f. Keep the nozzle in contact with the rim of the fuel tank or container opening at all time, until refueling is complete. Do not use a nozzle lock-open device.
 - g. Replace gasoline cap securely and wipe up spilled fuel.
 - h. If fuel is spilled on clothing, change clothing immediately.
5. Use extension cords and receptacles as specified by the manufacturer for all units with electric drive motors or electric starting motors.
6. Adjust the auger housing height to clear gravel or crushed rock surface.
7. Never attempt to make any adjustments while the engine (motor) is running (except when specifically recommended by the manufacturer).
8. Always wear safety glasses or eye shields during operation or while performing an adjustment or repair to protect from foreign objects that may be thrown from the machine.

PERSONAL PROTECTIVE EQUIPMENT

Always use the correct personal protective equipment when you operate the product. This includes, at minimum, sturdy footwear, eye protection and hearing protection. Personal protective equipment does not erase the risk of injury but may decrease the grade of injury if an accident occurs.

1. Always wear safety glasses or eye protection while you operate the product or do maintenance or repairs.
2. Always wear appropriate winter garments when you operate the product.
3. Always use heavy-duty slip-resistant boots with good ankle support while you operate the product.
4. Do not wear loose fitting clothing that can get caught in moving parts.
5. Use approved protective gloves, if necessary. For example, when attaching, examining or cleaning the blade.
6. Always use approved ear protection while you operate the product.
Noise for a long period can cause noise-induced hearing loss.

SAFETY DEVICES ON THE PRODUCT

1. Make sure that you regularly do the maintenance to the product.
 - a. The life of the product increases.
 - b. The risk of accidents decreases.

SAFETY INSTRUCTIONS

Let an approved dealer or an approved service center regularly examine the product to do adjustments or repairs.

2. Do not use a product with damaged protective equipment. If the product is damaged, speak to an approved service center.

MUFFLER SAFETY

The muffler keeps the noise levels to a minimum and sends the exhaust fumes away from the operator. Do not use the product if the muffler is missing or defective. A defective muffler increases the noise level and the risk of fire. Examine the muffler regularly to make sure that it is attached correctly and not damaged.



ATTENTION:

The muffler becomes very hot during and after use and when the engine operates at idle speed. Be careful near flammable materials to prevent fire.

FUEL SAFETY



WARNING

Read the warning instructions that follow before you use the product.

1. Do not start the product if there is fuel or engine oil on the product.
Remove the unwanted fuel and let the product dry.
2. If you spill fuel on your clothing, change clothing immediately.
3. Do not get fuel on your body, it can cause injury. If you get fuel on your body, use soap and water to remove the fuel.
4. Do not start the product if the engine has a leak. Examine the engine for leaks regularly.
5. Be careful with fuel. Fuel is flammable and the fumes are explosive and can cause injuries or death.
6. Do not breathe in the fuel fumes, it can cause injury. Make sure that there is a sufficient airflow.
7. Do not smoke near the fuel or the engine.
8. Do not put warm objects near the fuel or the engine.
9. Do not add the fuel when the engine is on.
10. Make sure that the engine is cool before you refuel.
11. Before you refuel, open the fuel tank cap slowly and release the pressure carefully.
12. Do not add fuel to the engine in an indoor area. Not sufficient airflow can cause injury or death because of asphyxiation or carbon monoxide.
13. Tighten the fuel tank cap fully. If the fuel tank cap is not tightened, there is a risk of fire.
14. Move the product a minimum of 3m (10ft) from the position where you filled the tank before a start.
15. Do not put too much fuel in the fuel tank.

SAFETY INSTRUCTIONS FOR MAINTENANCE



WARNING

Read the warning instructions that follow before you use the product.

SAFETY INSTRUCTIONS

1. The exhaust fumes from the engine contain carbon monoxide, an odorless, poisonous and very dangerous gas. Do not start the engine indoors or in enclosed spaces.
2. Before you do the maintenance on the product, stop the engine and remove the ignition cable from the spark plug.
3. Use protective gloves when you do maintenance on the blades. The blades are very sharp and cuts can easily occur.
4. Accessories and changes to the product that are not approved by the manufacturer, can cause serious injury or death. Do not change the product.
Always use accessories that are approved by the manufacturer.
5. If the maintenance is not done correctly and regularly, the risk of injury and damage to the product increases.
6. Only do the maintenance as given in this operator's manual. All other servicing must be done by an approved service agent.
7. Let an approved service agent do servicing on the product regularly.
Replace damaged, worn or broken parts.



WARNING!

Some dust created by power sanding, sawing, grinding, drilling and other construction activities contains chemicals known to the state of California to cause cancer, birth defects or other reproductive harm. Some examples of these chemicals are:

- Lead from lead - based paints
- Crystalline silica from bricks and cement and other masonry products, and
- Arsenic and chromium from chemically -treated lumber.

Your risk from these exposures varies, depending on how often you do this type of work.

To reduce your exposure to these chemicals: work in a well ventilated area, and work with approved safety equipment, such as those dust masks that are specially designed to filter out microscopic particles.

For more information go to www.P65warnings.ca.gov.

SAVE THESE INSTRUCTIONS

DESCRIPTION OF SYMBOLS

The following symbols may be used on this product. Please study them and learn their meaning. Proper description of these symbols will allow you to operate the product safely.



Precautions that involve your safety.



To reduce the risk of injury, user must read and understand the instruction manual before operating this product.



Wear eye protection. Always wear safety goggles or safety glasses with side shields.
Wear ear protection. Always wear full ear protection when operating this product.
Wear breathing protection.



Electric shock. Failure to use the starter in dry conditions and to observe safe practices can result in electric shock.



Risk of fire. Fuel and its vapors are extremely flammable and explosive. Fire can cause severe burns or death. Do not add fuel while the product is operating or still hot.



Toxic Fumes. The engine exhaust from this product contains chemicals known to cause cancer, birth defects and other reproductive harm.



Risk of asphyxiation. This engine emits carbon monoxide, a colorless, odorless poison gas. Breathing carbon monoxide can cause nausea, fainting or death. Use only in a well-ventilated area.



Thrown Objects. This machine may pick up and throw objects which can cause serious personal injury.



Always use chute tool. Never use your hands to clear a clogged chute assembly. Shut off engine and remain behind handles until all moving parts have stopped before unclogging.



Hot surface. do not touch. Exhaust gases, muffler and engine components are extremely HOT and cause burns.



Check oil level. Recommended oil is 5W-30. The engine can be seriously damaged without oil. Always check the oil level before use. The machine must be resting firmly on level ground when checking.



Safe Distance, By stander to keep a safe distance



Rotating Auger. Danger: Avoid injury from rotating auger. Keep feet away.



Wear protective gloves when using the machine and handling debris.



WARNING! Turn the machine OFF and disconnect it from the power supply before inspecting, cleaning, changing accessories, or conducting any other maintenance task.

DESCRIPTION OF SYMBOLS



Rotating Parts. Never put hand in the chute. Contact with rotating parts can hands.



Rotating Impeller. Never use your hands to clear a clogged chute assembly. Shut OFF engine and remain behind handles until all moving parts have stopped before unclogging.



Danger: Keep hands and feet away.



Fuel Shut off. Remove the engine key and fuel shut off.



Shut off engine and remove key before performing maintenance or repair work.



Use Clean, fresh, regular unleaded gasoline with a minimum octane rating of 87 and an ethanol content of less than 10% by volume.



Insert Ignition key.



Remove Ignition key.



Cold starting, Prime 3 times.



Warm starting, no need to Prime.



Move the fuel valve lever to the "ON" position.



Move the fuel valve lever to the "OFF" position.



Move the throttle lever to full speed.



Lower the speed of the engine.



Choke opened, when the engine starts, move the choke to the choke to "RUN" position.



Choke closed, to start a cold engine, move the choke lever to the "CHOKE" position.

PARTS LIST

KNOW YOUR SNOW BLOWER

Fig. 1

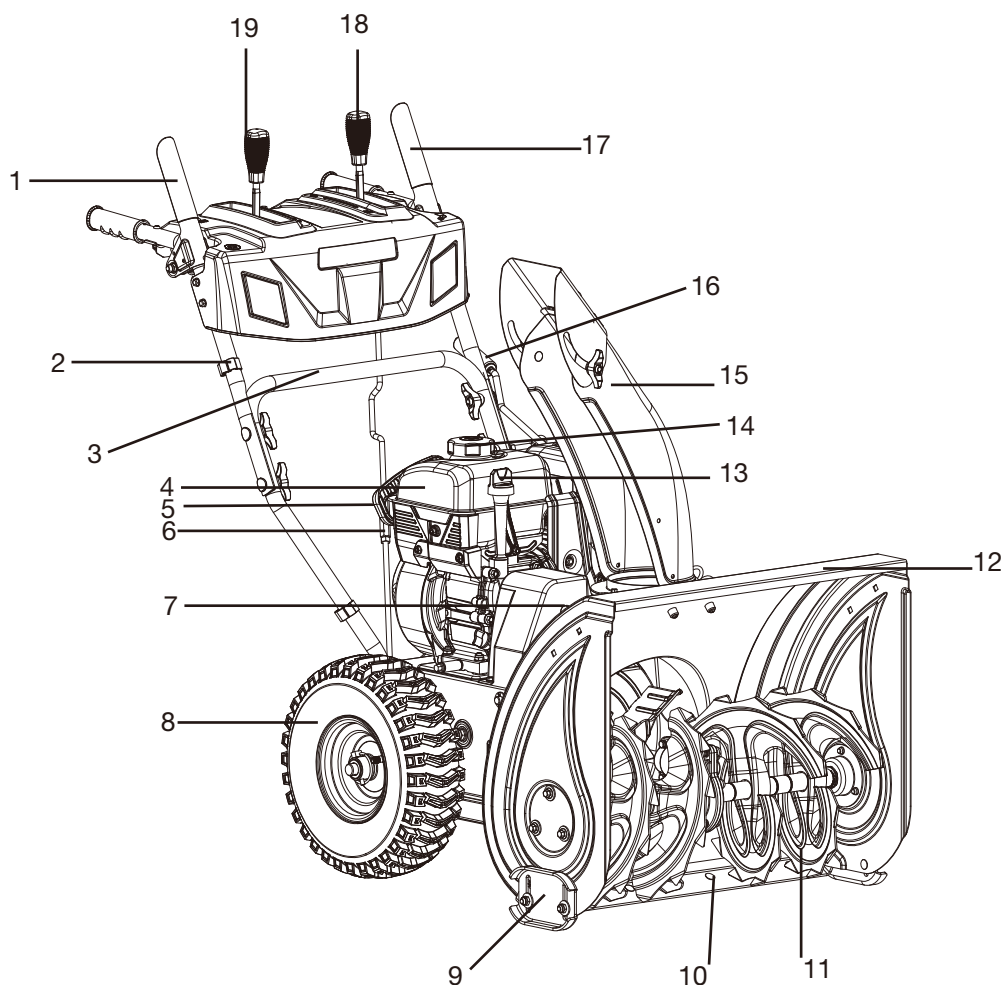

1. Drive Lever
2. Cable Clip
3. Lower Handle Assembly
4. Engine
5. Recoil start handle
6. Speed Control Rod
7. Clearing Tool
8. Wheel
9. Skid Shoes
10. Scraper Bar
11. Augers
12. Auger Housing
13. Oil Fill
14. Fuel tank cap
15. Chute assembly
16. Chute Rotator
17. Auger Lever
18. Chute Deflector Operating Lever
19. Shift Lever

Snow blowers allow you to clear snow quickly and efficiently. Refer to the following diagrams to become familiarized with all the parts and controls of your snow blower. The components will be referred to later in the manual for assembly and operation instructions.

PARTS LIST

PARTS LIST

Use two people to grasp the rear handle and the front part of the product at the same time and carefully lift the tool up and out of the carton. Remove any other accessories from the carton. Make sure that all items listed in the packing list are included.

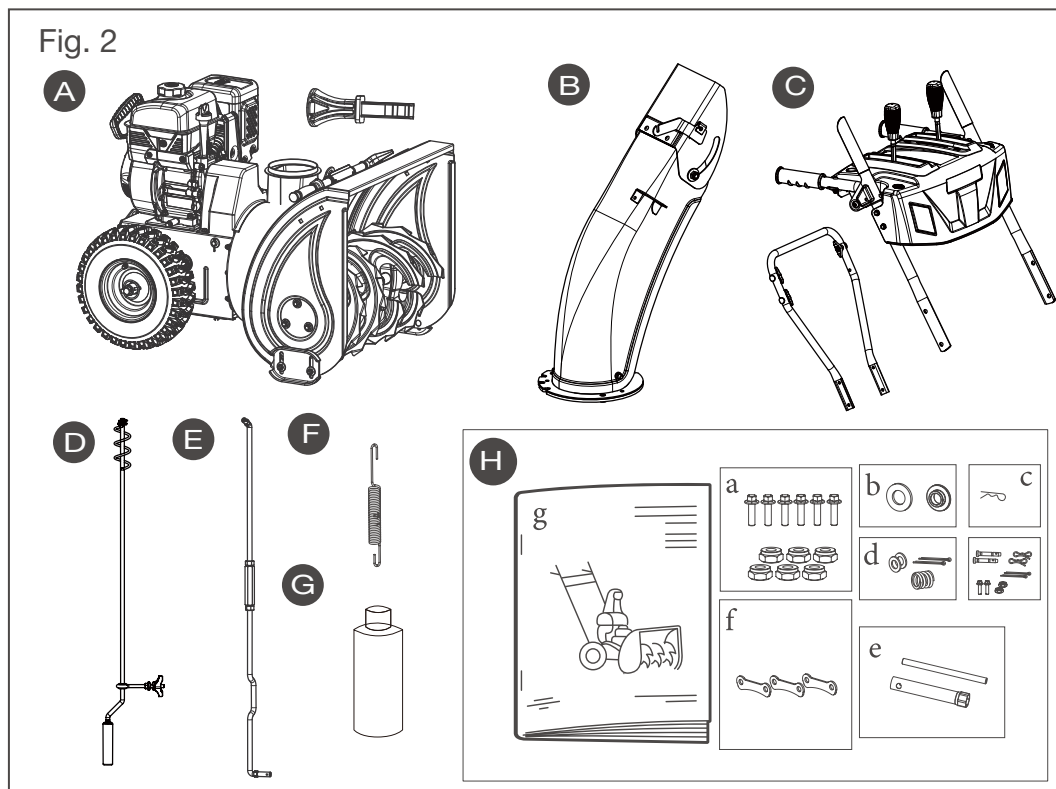

- A Main body of snow thrower *1pc
- B Chute assembly *1pc
- C Upper and lower handle *1pc
- D Chute rotating bar *1pc
- E Drive control rod *1pc
- F Chute Spring *1pc
- G Engine oil *1pc
- H Components
 - a) Bolt & nut *6pcs
 - b) 10mm Washer & Rotator * 1pc
 - c) Cotter Pin * 1 pc
 - d) 8mm Washer & Flat Cotter Pin * 2 pcs & Spring * 1 pc
 - e) Wrench & Handle* 1 pc
 - f) Positioning * 3 pcs
 - g) Users manual *1pc

PRODUCT SPECIFICATIONS

Some parameters may be changed due to improvement, only for reference, not for acceptance.

Engine Displacement	212cc
Gasoline capacity and type	2.2L(0.58 U.S.Gal)Unleaded regular (maximum 10% ethanol)
Oil type (API SJ-SN)	SAE 5W-30 (below 0°C (32°F))
Oil capacity	0.6 L (20oz)
Spark plug	F7RTC or equivalent spark plug
Spark plug electrode gap	0.7-0.8 mm
Tire pressure	138 kPa (20 psi)
Clearing Width	24 in
Intake Height	21 in
Throwing Distance	Up to 40 ft.
Wheel Size	14 in
Operating Temperature	-4°F-50°F(-20°C-10°C)
Storage Temperature	-4°F-158°F(-20°C-70°C)
Snow Blower Weight	162 lbs (74 kg)

ASSEMBLY



WARNING

Do not plug in or turn on the tool until it is fully assembled according to the instructions. Read through and become familiarized with the following procedures of handing and adjusting your tool. Failure to follow the safety instructions may result in serious personal injury.

To install the handles

1. Remove the four M8×25 flange bolts(A), spring spacer (B) and flat spacer (C) from the case.
2. Use the four M8×25 flange bolts (A), the four spring spacers (B) and the four flat spacers (C).
3. Install the lower handle (D) into the two holes on each side of the case. See Fig.3.

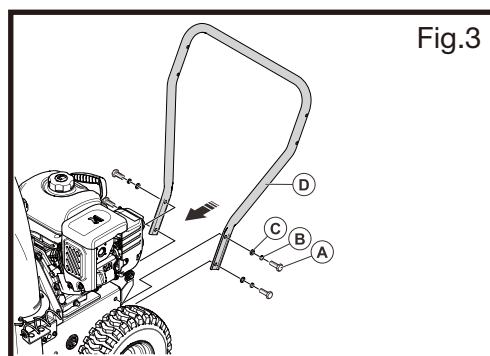

Fig.3

4. Insert the Z-shape cable head(B) into the hole on clutch handle(A) from inside to outside. The auger cable is on the left and drive cable on the right. See Fig.4.

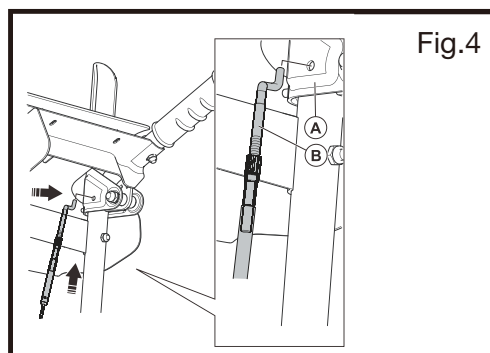

Fig.4



ATTENTION:

To install the upper handle onto the lower handle, you need to use the pre-installed knobs on the lower handle. Make sure the auger cable and drive cable are fixed on the clutch handles before installing the upper handle.

5. Use the three M8×50 handle lock bolts(A), the three spacers (B), the three handle knobs (C).
6. Install the upper handle (D) with the control panel on the lower handle. See Fig.5.

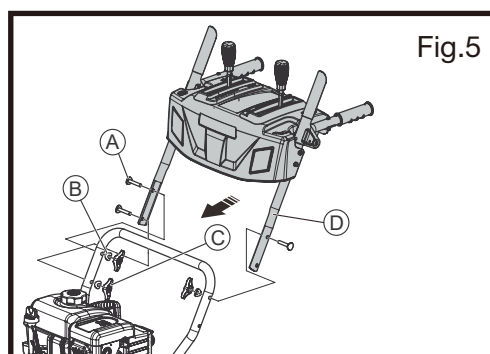
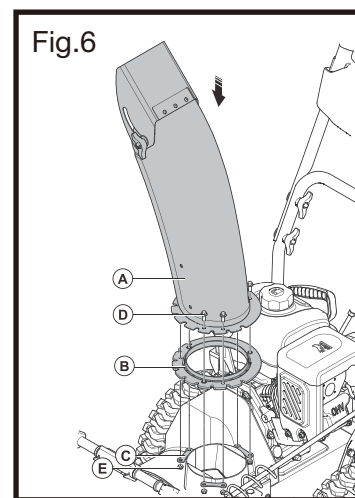

Fig.5

ASSEMBLY

To assemble the chute deflector

1. Remove the rotator disk (B) and the six M6×22 hexagon flange bolts (D) from the spare parts bag supplied.
2. Attach the rotator disk (B) and the chute deflector (A) onto the chute base using three limits blocks (C).
3. Use six M6×22 hexagon flange bolts (D) and six M6 locking nuts (E) to lock the limits blocks (C).
See Fig.6.



4. Thread the snow cap adjustment cable (A) into the cable seat.
See Fig.7.

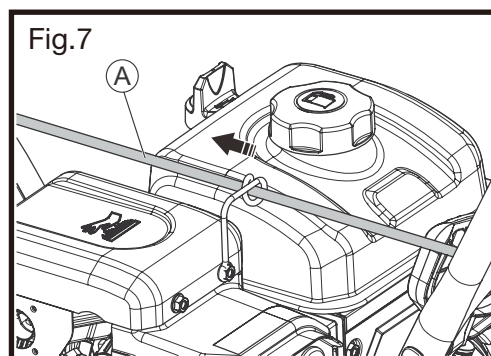

5. Insert the top cylinder (A) of the cable into the hole.
6. Put the cable screw (B) into the slot and tighten the nut M8 (C).
See Fig.8

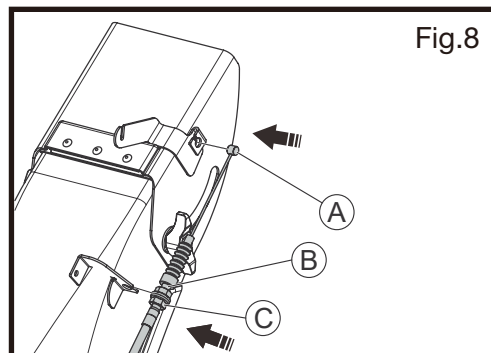

7. Install the long end of the snow outlet extension spring (A) into the upper slot, and the short end into the lower hole.
See Fig.9.

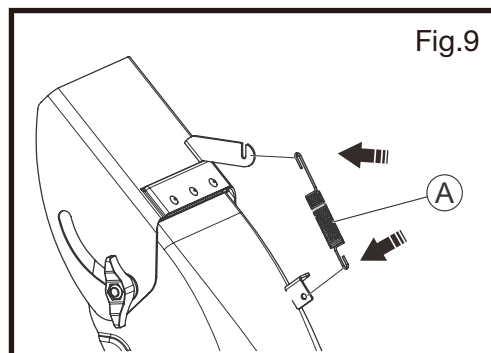

ASSEMBLY

To assemble the chute rotator

1. Assemble the front end of the chute rotator.
2. Install the plastic bushing (B) to the front end of the chute rotator.
3. Attach the chute rotator with one flat spacer (A) and one hairpin (C).
See Fig.10.

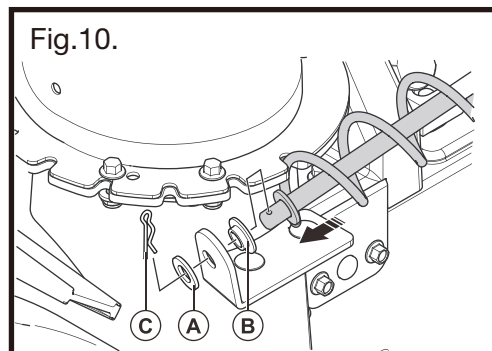

4. Assemble rear end of the chute rotator.
5. Use one plastic locking handle knob (A), two curve spacers (B) and one screw level (C) to assemble the chute rotator.
6. Use one hexagon nut M8 (D) to fix the chute rotator (E) into the holes of the handle.、
See Fig.11.

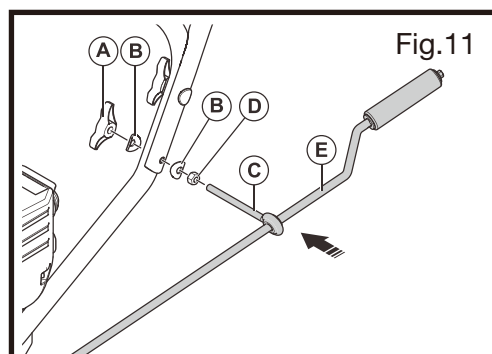

To assemble the drive speed control rod

1. Install the long bent end of the drive speed control rod (A) to the control panel, and attach it with one connecting rod spring (B), one flat spacer (C) and one cotter pin (D).
See Fig.12.

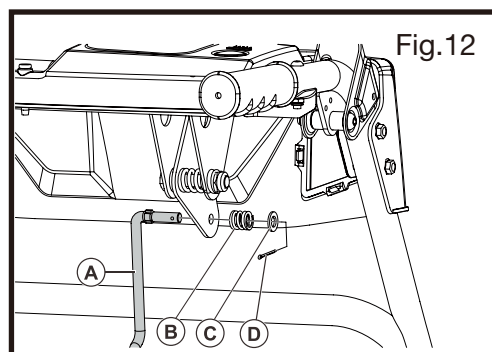

2. Pull up the shift connecting plate (B) and install the short bent end of the drive speed control rod (A). Attach the drive speed control rod (A) with one flat spacer (C) and one cotter pin (D).
See Fig.13.

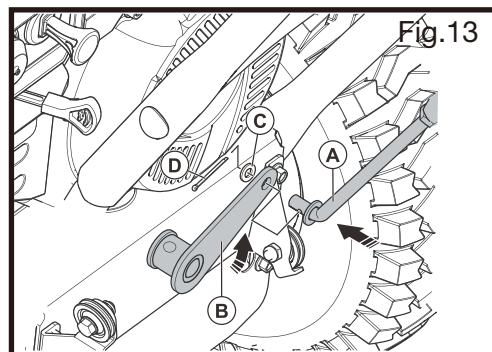

ASSEMBLY

To assemble the wire



ATTENTION:

If the product has LED lights or heating handle, proceed to the following assembly.

1. Connect the LED light and heating handle cable plug (B) to the engine output cable plug (A)
See Fig.14.
2. Use the hoop (B) to fix the LED light and the heating handle cable to the armrest assembly (A) .
See Fig.15

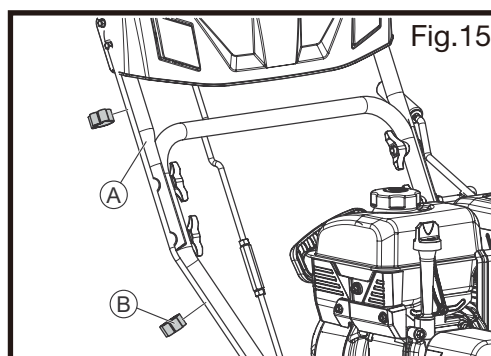
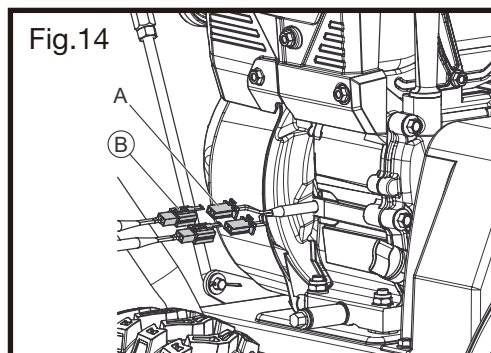

To assemble the wheel



ATTENTION:

It is forbidden to fix the wheel at the outer hole while machine is working. Otherwise the machine will be damaged.

1. P1: Working mode
2. P2: Transport mode

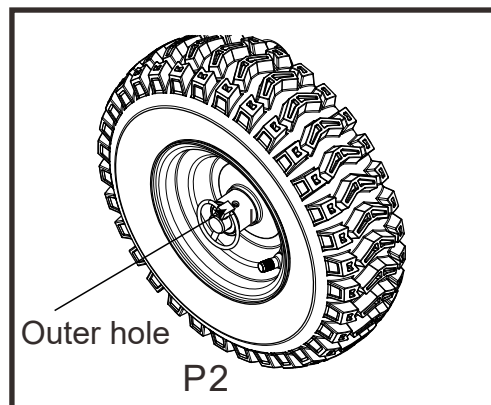
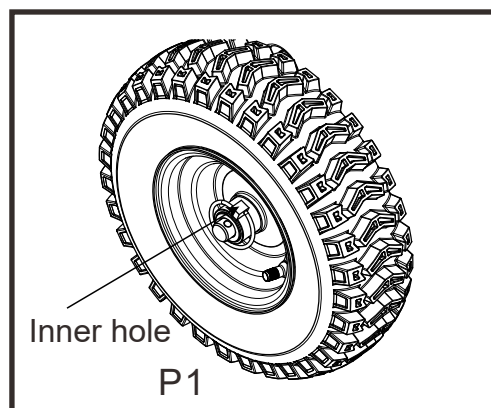

OPERATION

Before you start the product

1. Keep persons and animals away from the work area.
2. Do daily maintenance. See Maintenance on page 26.
3. Make sure the ignition lead fits correctly on the spark plug.
4. Add oil or gasoline, if necessary. See Technical data on page 12.

To fill the engine with oil



ATTENTION:

Do not rotate the dipstick when you check the oil. Do not fill above the mark.

1. Remove the oil cap and clean the dipstick.
2. Add oil to the top mark on the dipstick. Use the dipstick to examine the oil level at regular intervals.
3. Put the oil cap back.
See Fig.16.

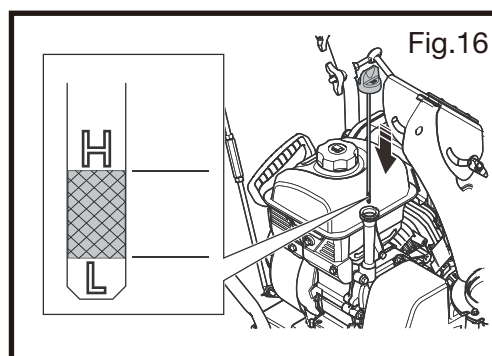

To fill fuel

If available, use low-emission/alkylate gasoline. If low-emission/alkylate gasoline is not available, use good quality unleaded gasoline or leaded gasoline. Use gasoline with an octane number of 90 RON or higher, and with a maximum of 10% ethanol (E10).



ATTENTION:

Do not use gasoline with an octane number less than 90 RON. This can cause damage to the product.

1. Open the fuel tank cap slowly to release the pressure.
2. Fill slowly with a fuel can. If you spill fuel, remove it with a cloth and let remaining fuel dry off.
3. Clean the area around the fuel tank cap.
4. Tighten the fuel tank cap fully. If the fuel tank cap is not tightened, there is a risk of fire.
5. Move the product a minimum of 3 m (10 ft) from the position where you filled the tank, before a start.

To adjust the chute deflector

The direction in which snow is to be thrown is controlled by the chute rotator control which is installed on the left side handle.

1. Rotate the chute rotator control to set the rotating direction of throwing snow.
2. Rotate the chute rotator control clockwise to throw snow rightwards.
3. Rotate the chute rotator control counter-clockwise to throw snow leftwards.
See Fig.17.

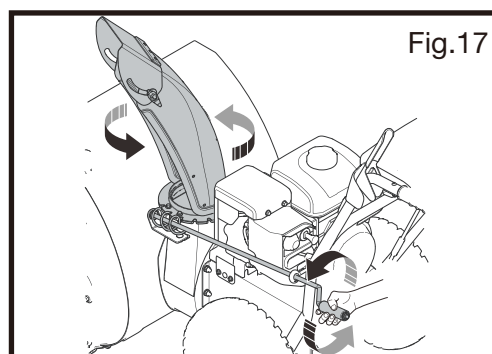

OPERATION

4. Move the angle deflector up or down to adjust the throwing distance of the snow.
See Fig.18 and 19.



Note!

If the angle deflector can't reset freely, please adjust the knob

To start the engine

1. Release the drive engagement. Put the drive speed control lever in the F1 position.
2. Turn the fuel switch to the ON position.
See Fig.20.

3. Turn the choke to the CLOSE position.
See Fig.21.

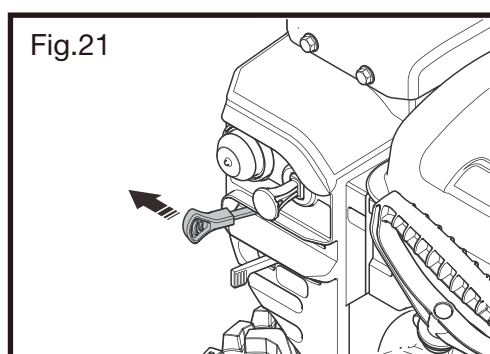
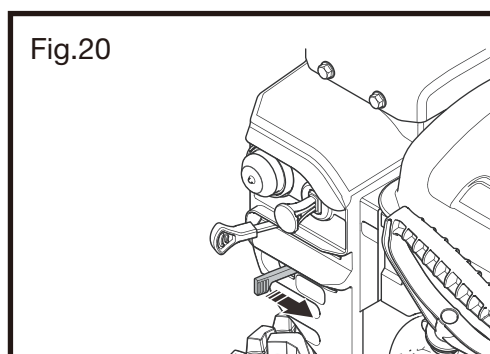
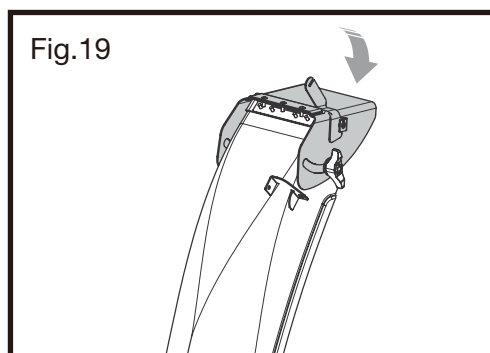
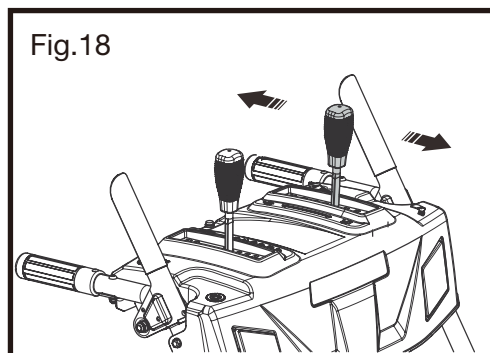

OPERATION

4. Push in the engine key to the RUN position
See Fig.22.

Fig.22

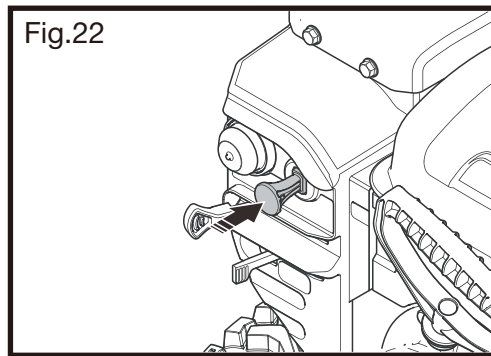

5. Push the primer 3 times to start the booster pump. Use the booster pump for cold start in low temperatures.
See Fig.23.

Fig.23

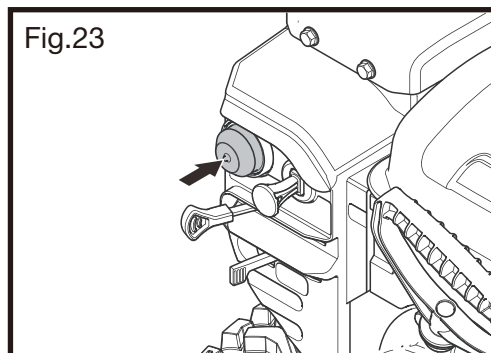

ATTENTION:

Do not release the recoil start handle quickly.
Move it back to the start position slowly.

6. Pull the recoilstart handle to pull the rope out slowly, until you feel resistance, then pull briskly. When the engine starts, return the starter rope normally. See Fig.24.

Fig.24

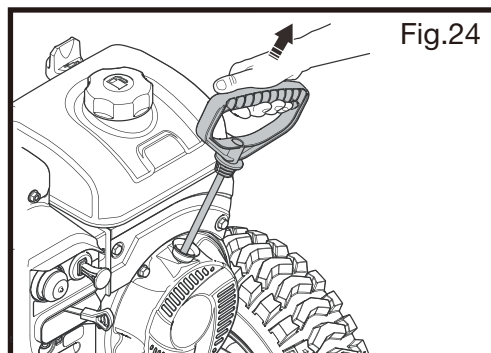

7. Run the engine 30-40 seconds before you start to throw snow.
8. When the engine is warm, slowly move the choke to the OPEN position.
See Fig.25.

Fig.25

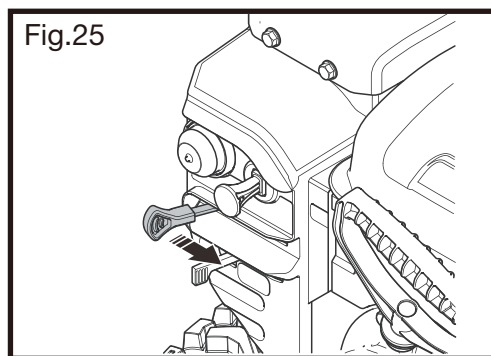

To start the engine, electric start(if equipped)



WARNING:

The product has a 120 Volt A.C. electric starter. Ensure that your house is a three-wire grounded system which meet the nameplate. If you are uncertain, consult a licensed electrician.

OPERATION



ATTENTION:

Use an extension cord that is recommended for outdoor use, and that is not longer than 50 feet (15 m).

1. Perform 1-5 actions in "to start the engine".
2. Connect the product to power.
See Fig.26.

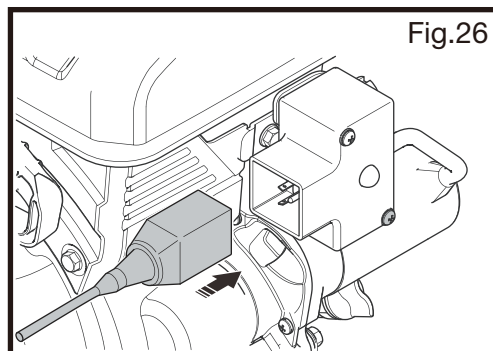

Fig.26

3. Press the start button to start the engine, release it quickly after starting, and do not press it for more than 5 seconds each time
4. If the engine does not start, wait 5 seconds, then push the start button again.
See Fig.27.

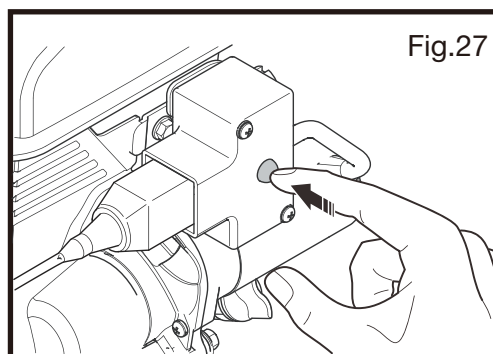

Fig.27



ATTENTION:

Do not try to start the engine more than 10 times.
After 10 times, wait 40 minutes before you try again.

5. Run the engine 30-40 seconds before you start to throw snow.
6. When the engine is warm, slowly move the choke to the OPEN position
See Fig.28.

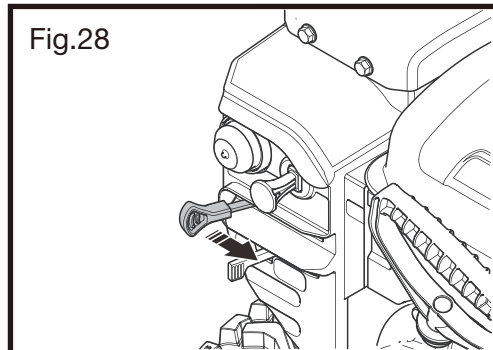

Fig.28

To operate the product

1. Squeeze the auger engagement to the handle to engage the auger and throw snow.
See Fig.29.

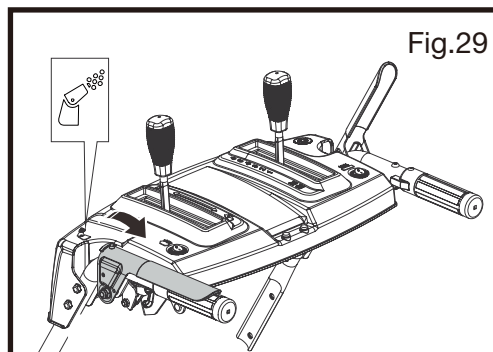
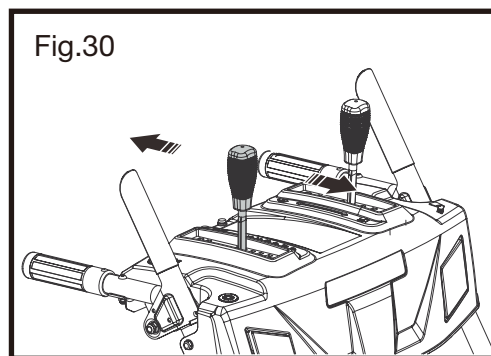

Fig.29

OPERATION

2. Move the drive speed control lever forward to operate the product forward. Move the drive speed control lever back to operate the product rearward.
See Fig.30.



4. Operate the drive engagement with the right handle.
5. Squeeze the drive engagement to the handle to engage the drive wheels. The product moves forward or reverse depending on the location of the drive speed control lever.
See Fig.31.

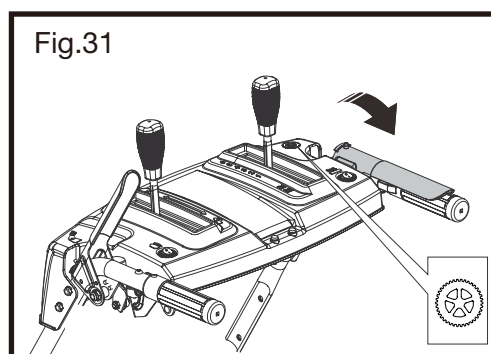

- ! ATTENTION:** If the product has Single-Hand Operation, proceed to the following assembly.
6. After pressing the left and right handles, the clutch handles of the stirring cage can be released, and the whole machine can walk and clear snow at the same time.
See Fig.32.

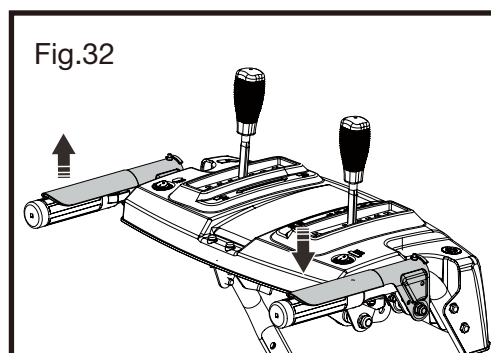

To operate the heating handle(If equipped)

- ! ATTENTION:** When the engine is working, the heating handle can be used normally.
1. After starting the engine, press the icon "—" key to the heating handle starts heating, press the "o" icon key to the heating handle stop heating.
See Fig.33.

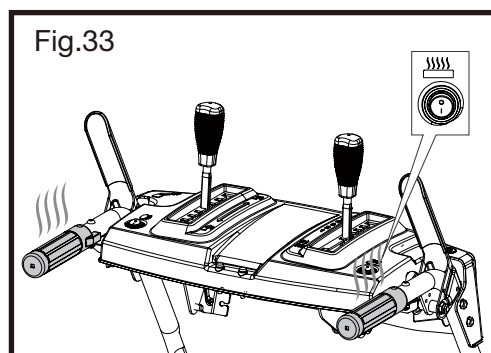

OPERATION

To operate LED lights



ATTENTION :

When the engine is working, the LED light can be used normally.

1. After the engine starts, press the "—" icon key to light up the lamp, and press the "o" icon key to turn off the lamp.
See Fig.34.

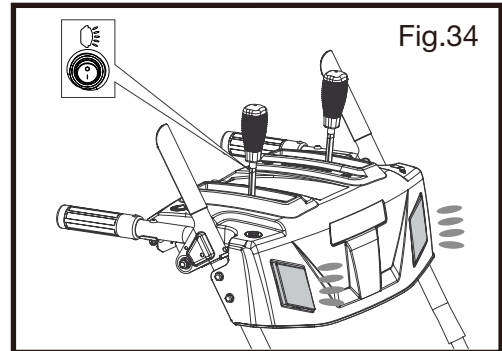

To stop the product



ATTENTION:

To turn the engine off in an emergency, pull out the on/off key.

1. Release the drive engagement to stop the drive wheels.
2. Release the auger engagement to disengage the auger and stop throwing snow.
See Fig.35.

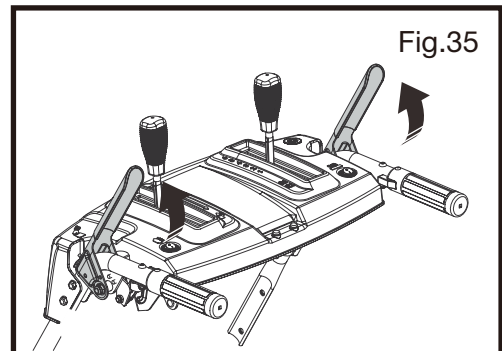

3. Turn the fuel switch to the OFF position(left).
See Fig.36.

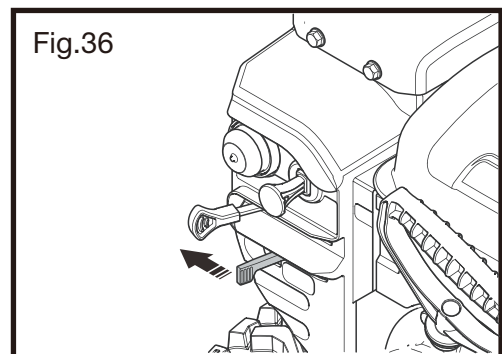

4. Pull out the engine key to the OFF position.
See Fig.37.

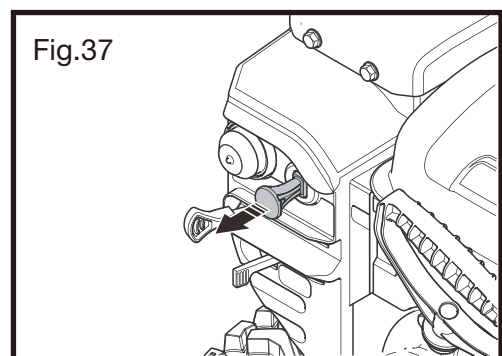

To get a good result

1. Always run the engine at full throttle or close to full throttle.
2. Always adapt the speed of the product to the snow situation and adjust the speed with the drive speed control lever. Make sure that the product throws snow evenly.
3. It is easier and more efficient to remove snow immediately after it falls.
4. Always throw snow downwind whenever possible.
5. On flat surfaces, like asphalt roads, raise the scraper bar up to 5-6 mm (0.2-0.25 in) from the ground.
6. On uneven surfaces, like gravel roads, raise the scraper bar slightly above the top of the gravel. Make sure that the gravel and stones do not enter into the product. It will cause personal injuries if those foreign objects are ejected at high speed.
7. Do not dispatch the chute deflector if it is clogged.
8. If the product does not move forward due to unforeseen circumstances, release the drive engagement immediately or pull out the on/off key to OFF position.

MAINTENANCE AND STOARGE

Maintenance schedule

Maintenance	Daily	20 hours	50 hours	100 hours	150 hours
Make sure that nuts and screws are tightened	×				
Do a check of the engine oil level	×				
Replace oil 1		×	×	×	
Make sure there are no fuel or oil leaks	×				
Remove clogging,foreign objects in auger	×				
Inspect the tire pressure 2			×		
Inspect and change the spark plug 3				×	

1. Replace the oil after the first 20 h, 50 h, 100 h and then every 100 h.
2. See Technical data on page 32 for correct tire pressure.

To do a general inspection

Make sure that the nuts and screws on the product are tightened.

To do a check of the oil level



ATTENTION:

A too low oil level can do damage to the engine. Do a check of the oil level before you start the product.

1. Put the product on level ground.
2. Remove the oil tank cap with the attached dipstick.
3. Clean the oil from the dipstick.
4. Put the dipstick fully into the oil tank to give a correct picture of the oil level.
5. Remove the dipstick.
6. Examine the oil level on the dipstick.
7. If the oil level is low, fill with engine oil and do a check of the oil level again.

To replace the engine oil



ATTENTION:

The engine oil is hot. Avoid skin contact with the used engine oil.

1. Run the engine a few minutes to make the oil warm. Warm oil flows better and carries more contaminants.
2. Put the product on level ground.
3. Run the engine until all fuel has been depleted.
4. Remove the ignition key.
5. Put a container under the oil drain plug.
6. Remove the oil drain plug, tip the product backwards and drain the used oil in the container.
7. Put the product back to the operating position.
8. Fit the oil drain plug and tighten it securely by hand.
9. Fill the engine with oil, see To fill the engine with oil on page 17.

See Fig.38.

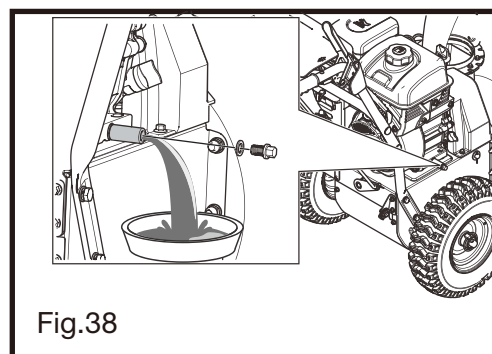

Fig.38

MAINTENANCE AND STOARGE

To examine the spark plug

**ATTENTION:**

Always use the recommended spark plug type. Incorrect spark plug type can cause damage to the product.

**ATTENTION:**

Always use the recommended spark plug type. Incorrect spark plug type can cause damage to the product.

1. Examine the spark plug if the engine is low on power, is not easy to start or does not operate correctly at idle speed.
2. To decrease the risk of unwanted material on the spark plug electrodes, obey these instructions:
 - a Make sure that the idle speed is correctly adjusted.
 - b. Make sure that the fuel mixture is correct.
 - c. Make sure that the air filter is clean.
3. If the spark plug is dirty, clean it and make sure that the electrode gap is correct, see Technical data on page 12.
4. Replace the spark plug if it is necessary.
5. Check and clean spark plug before use each year. See Fig.39.

Fig.39

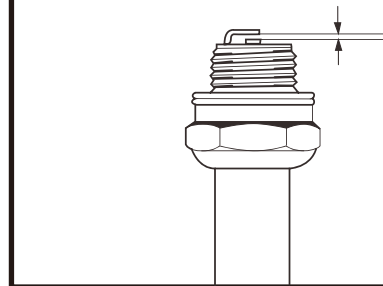

To inspect the augers and the scraper bar

1. Before each use, inspect the augers and the scraper bar for wear.
2. If the edges of the augers or the scraper bar are worn, contact an authorized service center to replace them.

To adjust the skid shoes

No adjustment is required for normal installation.

1. When the lock nut (B) is loose or the skid shoe (A) is not high enough from the ground, unlock the lock nut (B).
2. On flat surfaces, like asphalt roads, make the clearance 5-6mm (0.2- 0.25 in) higher between the skid shoes (A) and the ground with a 13 mm open-ended wrench. On uneven surfaces, like gravel roads, raise the scraper bar slightly above the top of the gravel. Make sure that the gravel and stones do not enter into the product. It will cause personal injuries if those foreign objects are ejected at high speed.
3. Fasten the lock nut (B). See Fig.40.

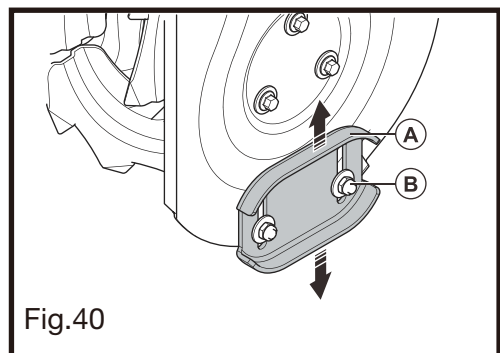

Fig.40

To replace the shear pin

The shear pin protects the product from damage. It breaks if a foreign object enters the moving parts.

1. If the shear pin breaks, stop the engine.
2. Attach a new shear pin (A) and a new clamp spring (B). See Fig.41.

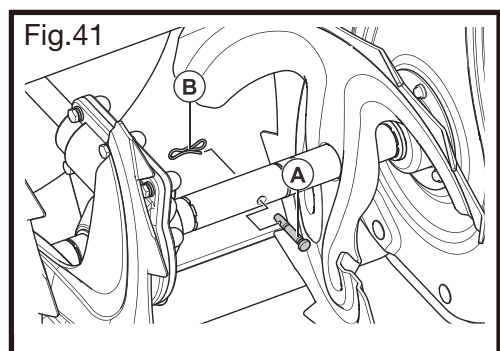

Fig.41

MAINTENANCE AND STOARGE

To examine the tires

1. Keep the tires free of fuel, oil and chemicals to prevent damage to the rubber.
2. Keep the tires away from stumps, stones, ruts, sharp objects and other objects which can cause damage to the tires.
3. Keep the tire pressure correct, see Technical data on page 12.

To clear a clogged chute deflector



WARNING:

Do not unclog the chute deflector if it is clogged before the following operations are made.

1. Release the auger engagement and the drive engagement at the same time.
2. Wait 10 seconds to make sure that the augers have stopped.
3. Use the included clean-out tool to remove the clog.

To clean the product

1. Clean plastic parts with a clean and dry cloth.
2. Do not use a high pressure washer to clean the product.
3. Do not flush water directly on the motor.
4. Use a brush to remove leaves, grass and dirt.

TROUBLESHOOTING

IF THESE SOLUTIONS DO NOT SOLVE THE PROBLEM CONTACT CUSTOMER SERVICE.

PROBLEM	POSSIBLE CAUSE	SOLUTION
The product does not start	The safety ignition key is not inserted.	Insert the safety ignition key.
	The product is out of fuel.	Fill the fuel tank with fresh, clean gasoline.
	The on/off key is OFF.	Move the on/off key to ON position.
	The choke is in OFF (CLOSE) position.	Move the choke to ON (FULL, OPEN) position.
	The primer is not depressed.	Press the primer.
	The engine is flooded.	Wait a few minutes before restarting, DO NOT prime.
		Restart the engine while full throttle and the choke in OFF (CLOSE) position.
	The spark plug wire is not connected.	Connect the wire to the spark plug.
	The spark plug is bad.	Replace the spark plug.
	There is water in the fuel or the fuel is too old.	Empty the fuel tank and carburetor. Fill the fuel tank with fresh, clean gasoline.
	There is vapor locked in the fuel line.	Make sure that all the fuel line is below the outlet of the fuel tank. The fuel line should run continuously down from fuel tank to carburetor.
	Other causes.	Inspect the starting procedures carefully in this manual.
Decreased power	The fuel switch (if so equipped) is in CLOSE (OFF) position.	Turn the fuel switch to OPEN(ON) position.
	The spark plug wire is not connected.	Connect the wire to the spark plug.
	The product throws too much snow.	Decrease the speed and the width of the swath.
	The fuel tank cap is covered with ice or snow.	Remove the ice and the snow on and around the fuel tank cap.
	The muffler is dirty or clogged.	Clean or replace the muffler.
	Improper cable length.	Adjust the cable.
	The muffler is blocked.	Make sure that the engine is cool. Clear the blockage.
	The air intake of the carburetor is blocked.	Make sure that the engine is cool. Clear the blockage.

TROUBLESHOOTING

The engine idles or runs roughly	The choke is in ON (FULL, OPEN) position.	Move the choke to OFF (CLOSE) position.
	The fuel line is blocked.	Clean the fuel line.
	There is water in the fuel or the fuel is too old.	Empty the fuel tank and carburetor.
		Fill the fuel tank with fresh, clean gasoline.
	The carburetor needs to be replaced.	Contact an authorized service center.
Excessive vibration / Handle movement	The belt is stretched.	Replace the auger v-belt.
	Some parts are loose. The augers are damaged.	Tighten all fasteners. Replace the damaged parts. If vibration remains, contact an authorized service center.
	The handles are not positioned correctly.	Make sure that the handles are locked into position.
The recoil start handle is hard to pull	The adjustment lever nuts are loose.	Tighten the nuts until the handle feels safe.
	The recoil start handle is frozen.	Slowly pull out as much rope out of the starter as possible and release the recoil start handle. If the engine does not start, repeat the procedure or use the electrical starter.
Loss of traction drive/ slowing of drive speed Loss of snow discharge or slowing of snow discharge	The rope is interfering with components.	The recoil rope should not touch any wires or hoses.
	The belt slips.	Adjust the cable. Adjust the belt.
	The belt is worn.	Check / replace the belt.
	The belt is off the pulley.	Check / reinstall the belt.
	The chute deflector is clogged.	Clean the chute deflector.
	Foreign objects clog the augers.	Remove the debris or the foreign object from the augers.
	The shear pin is broken.	Replace the broken shear pin.
	Excessive snow and ice build up in between track components track components.	Remove snow and ice build up from in between track components.
	The friction drive wheel is worn.	Contact an authorized service center.
Failure of auger rotation after the grip is released	The drive belt is not aligned.	Adjust the drive belt.
	The discharge deflector is not aligned.	Adjust the discharge deflector.
The lights are not on (if so equipped)	The engine is not running.	Start the engine.
	The wire connection is loose.	The wire connection is loose.
	The LED is burnt out.	Replace the LED light module. Individual LEDs can not be replaced.

TROUBLESHOOTING

The chute rotator is difficult to move	There is debris in the chute rotator mechanism.	Clean the internal parts of the chute rotator mechanism.
	The cables are kinked or damaged.	Make sure that the cables are not kinked. Replace the cables that are damaged.
The product turns to one side	The tire pressure is not equal.	Adjust the tire pressure and fill the tire.
	The product drives with only one wheel.	Inspect the tire lock pin.
	Uneven sled adjustment.	Adjust the skid plates and the sledge.
	Uneven skid plates adjustment.	Adjust the skid plates and the sledge.

TRANSPORTATION, STORAGE AND DISPOSAL

Transportation and storage

1. For storage and transportation of the product and fuel, make sure that there are no leaks or fumes. Sparks or open flames, for example from electrical devices or boilers, can start a fire.
2. Always use approved containers for storage and transportation of fuel.
3. Empty the fuel tank before you put the product in storage for a long period of time. Discard the fuel at an applicable disposal location.
4. Safely attach the product during transportation to prevent damage and accidents.
5. Keep the product in a locked area to prevent access for children or persons that are not approved.
6. Keep the product in a dry and frost free area.

Disposal

1. Obey the local recycling requirements and applicable regulations.
2. Discard all chemicals, such as engine oil or fuel, at a service center or at an applicable disposal location.
3. When the product is no longer in use, discard it at a recycling location.

WARRANTY

WARRANTY

Product Warranty

Please keep your original purchase receipt in a safe place as proof of purchase.

The warranty period begins on the day that the product was purchased from an authorized retailer of Yard Force products. Warranty coverage for this product must be verified by the original purchase receipt.

Yard Force products. Warranty coverage only applies to the original purchaser and is not transferrable.

Warranty coverage is only provided on products purchased from authorized Yard Force retailers.

Warranty only applies to products purchased and OPERATED in the USA. Any product purchased or operated outside of the USA is not covered by any warranty.

(2) Two-Year Limited Warranty

The snow blower has a 2-Year Limited Warranty from the date of purchase against manufacturer defects for residential use only. Commercial use voids the warranty. This warranty does not cover accidental damage, unreasonable use, normal wear and tear, neglect or non-compliance with the Operating, Safety and Maintenance Instructions. All service, outside of normal maintenance as described in this manual, must be done by an authorized service technician. Any unauthorized service or changes to the original configuration of this product will void the warranty. All parts and accessories used on and with this product must be manufactured and or authorized by Merotec Inc.

(90) Ninety-Day Warranty – Components

The accessories included with the snow blower including the auger, belt and other similar parts are warranted against manufacturer defects for residential use only for a period of 90 days from date of purchase.

Warranty does not cover loss of use or other consequential damages arising from any of the above, nor does it cover repairs made or attempted by unauthorized persons.

This warranty is void if the product is used for commercial, rental or industrial purposes.

Certain parts, attachments and accessories are subject to normal wear and tear and are excluded from the warranty.

Service and Warranty Claims Process

Contact the Yard Force Support Center toll-free at **(866) 902-9690 Monday-Friday between 8:30 AM and 5:00 PM Eastern Time** for service and warranty support.

Yard Force Service Support agents can help you troubleshoot problems over the phone to get you back up and running as quickly as possible. In the situation where service or warranty inspection is needed, please follow these steps:

1. Call Yard Force at **(866) 902-9690 Monday-Friday between 8:30 AM and 5:00 PM Eastern Time**.
2. Send in proof-of-purchase and serial number (if applicable) to confirm warranty Coverage as directed by Yard Force.
3. If service or a warranty evaluation is requested, Yard Force will provide an RGA number that should be used in all communications with Yard Force and is required to be indicated on the product itself and on the outside of the box.
4. All shipments to Yard Force must have an RGA number. Any shipment received that does not have an RGA number clearly marked on the outside of the box will be refused.
5. All shipments must be sent pre-paid, Yard Force does not pay for any shipping costs for service or warranty evaluation. Yard Force is not responsible for any packages that are lost by carrier. We recommend that shipments are made by a carrier that provides tracking and delcert confirmation

For more information or to ask questions, please call toll-free **(866) 902-9690 Monday-Friday between 8:30 AM and 5:00 PM Eastern Time**.

SAVE THESE INSTRUCTIONS



Need Help?

Please do not return the product to your place of purchase yet. We're here to help and take care of all your needs.

Contact our customer service department for help with:

- Product assembly or use
- Missing or damaged parts
- Troubleshooting
- Replacement parts and accessories

You can submit a support request by scanning the QR code on this page, or by visiting:
www.YardForceUSA.com/contact-support

Scan Code to connect with Yard Force Support



1-866-902-9690



www.YardForceUSA.com

Register your product today to maintain warranty coverage and stay up to date with information on the use, care, maintenance and service of your product.

Register online today at:

www.yardforceusa.com/product-registration



Merotec Inc.
3655 Kennesaw North Industrial Parkway
Kennesaw, GA 30144
Copyright © 2023 Merotec Inc.

Part Number: YF24-DS21-GSB3MAN-B
202302